

## Frame anchor with hex head HRD-K



### Base materials

- Concrete (aerated)
- Concrete (cracked)
- Concrete (hollow deck)
- Concrete (uncracked)
- Masonry (grout-filled CMU)
- Masonry (hollow)
- Masonry (hollow CMU)
- Masonry (solid)

### Applications

- Fastening metal substructures for ventilated facades
- Typical applications for metal fabricators such as fastening handrails, window bars, railings, balustrades, etc.

### Advantages

- Flexible embedment depth (approved at 50 mm and 70 mm embedment depth) - the ideal anchor for a huge range of applications in virtually all base materials
- Suitable for fastening thicknesses up to 90 mm (anchor lengths from 60 mm to 140 mm)
- Available in carbon steel and A2 stainless steel

### Technical data

<b>Material composition</b>	Steel, zinc-plated (min. 5 µm), Polyamide
<b>Head configuration</b>	Hex head
<b>Anchor size</b>	10 mm
<b>Suitable for cracked concrete with redundant fastenings</b>	Yes

Ordering designation	Drill bit diameter	Anchor length	Embedment depth 1	Fastening thickness at embed.1	Bit size	Screw head diameter	Sales pack quantity	Item number
HRD-K 10x60	10 mm	60 mm	50 mm	10 mm	T40	18 mm	50 pc	423878 <sup>1)</sup>

<sup>1)</sup> This is a non-stock item. For detailed lead time information please contact your Hilti representative.

Please visit our website for the latest item numbers and related products.

### Approvals

ETA | ETA-07/0219 for HRD (ETAG 020-01, Option -)

Approvals and test reports may apply to selected products only. Please refer to the documents for details.

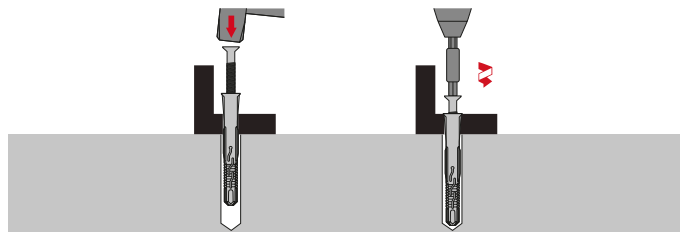

These are abbreviated instructions which may vary by application. Always review/follow the instructions accompanying the product or refer to [www.hilti.com/techlib](http://www.hilti.com/techlib).